



## GORAN SENSOR

bulb not included

voltage: 230V	GU10 1x MAX 35W
IP44	
	installation place

### COLOUR / NEW INDEX NO.

- BLACK (BK) . . . . . **AZ4695**
- DARK GRAY (DGR) . . . . . **AZ4696**
- WHITE (WH) . . . . . **AZ4697**

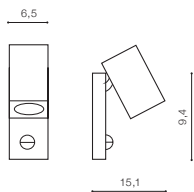

TILT 90°

## MASTER SLAVE SYSTEM

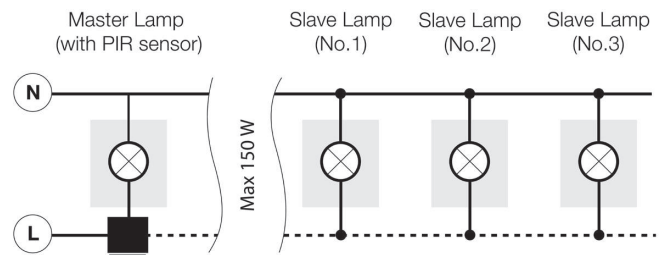

**One lamp with a PIR sensor** (passive motion sensor) is enough to turn on all other lamps connected to the Master line (in the diagram it is marked with a dashed line).

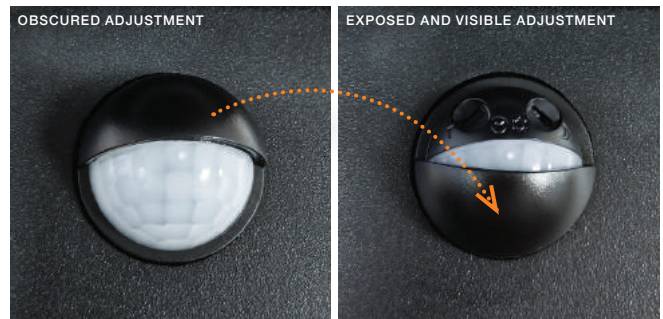

**TIME** – LIGHTING TIME ADJUSTMENT

**LUX** – DUSK SENSITIVITY ADJUSTMENT



**TIME**



**LUX**

